

CERTIFIED RECORD OF LAND CORNER MONUMENTATION

History of original corner establishment:

Corner established in 1881 by Henery W. Cooke, Under General Land Office Contract No. 422. Surveyor Generals Notes State: Set a basalt stone 14x12x12x" 10" in ground for 1/4 section corner marked 1/4 on W face.

From which:

A Pine 42" dia. bears S55°E, 192 lks dist. marked 1/4 S BT.
No other trees within limits and raised a mound of stone alongside.

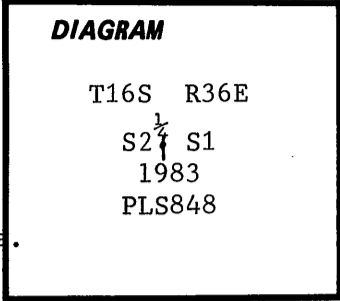

Description of corner evidence found:

Found a 16"x12"x8" stone, no marks visible, stone is rough, with a mound of stone alongside.

From which:

Found a Pine 34" dia. with scribing visible, bears S56°21'E, 124.7 ft. Accepted stone as the 1/4 corner position.

Description of monument and accessories established to perpetuate the original location of this corner:

Set a 30"x2" aluminum pipe with a 3 1/2" aluminum cap stamped as shown in diagram. Set 18" in ground, set original stone West alongside & raised a mound of stone around pipe.

From Which:

A Mahogany 10" dia. bears S8°W, 30.8 ft. scribed 1/4 S2 BT.
A " 5" " " S86 E, 24.4 ft. " " S1 BT.

Set a steel post with warning & boundry signs South 6 ft.

Nailed brass washers stamped PLS848, bearing tree & warning signs to wach tree.

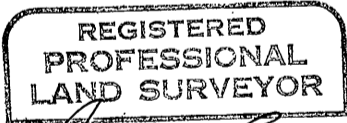

Corner monumented 7-29-83

Witnessed by D. Mitchell Ferguson

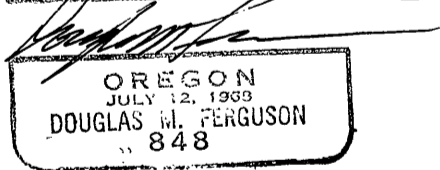

Office of...Surveyor..... County of...Grant.....

State of...Oregon....., I hereby certify that the within instrument was filed in this office

for record on the 29th day of...August....., 1983..

Robert D. Bandy by

(COUNTY OFFICIAL)

(DEPUTY)